



UNIONE EUROPEA



REPUBBLICA ITALIANA



REGIONE AUTÒNOMA DE SARDIGNA  
REGIONE AUTONOMA DELLA SARDEGNA

# The Castle della Fava

Patrimonio culturale  
**SARDEGNA** Virtual Archaeology



## ■ History of excavations and studies

The first scholar to mention the Castello della Fava was Giovanni Francesco Fara, who in the sixteenth century called it "*multis proeliis clarum [...] natura et arte munitum*" (= famous for its numerous battles [...] fortified by nature and the work of man). The Arago-nese historian Jerónimo Zurita also does not exclude that the monument was erected in a period preceding the domination by the people of Pisa and that these had further enhanced it when they had to defend the Posada territory during the invasion by Aragon. Some scholars subsequently talked about Posada referring to the origin and construction of the castle: thus Vittorio Angius stated that, with the introduction of modern artillery, the castle underwent restoration in order to adjust to the new fighting techniques, whilst Alberto Della Marmora in his *Itinéraire* hypothesised that the castle was built by the Giudici of Gallura or by the Genoese (fig. 1); finally, Luigi Oggianu, not being satisfied with any of the cases thus far proposed, conjectures that the Posada fortress was erected by workers from Pisa, without being able to determine however whether the client was the Visconti family or the Municipality of Pisa.

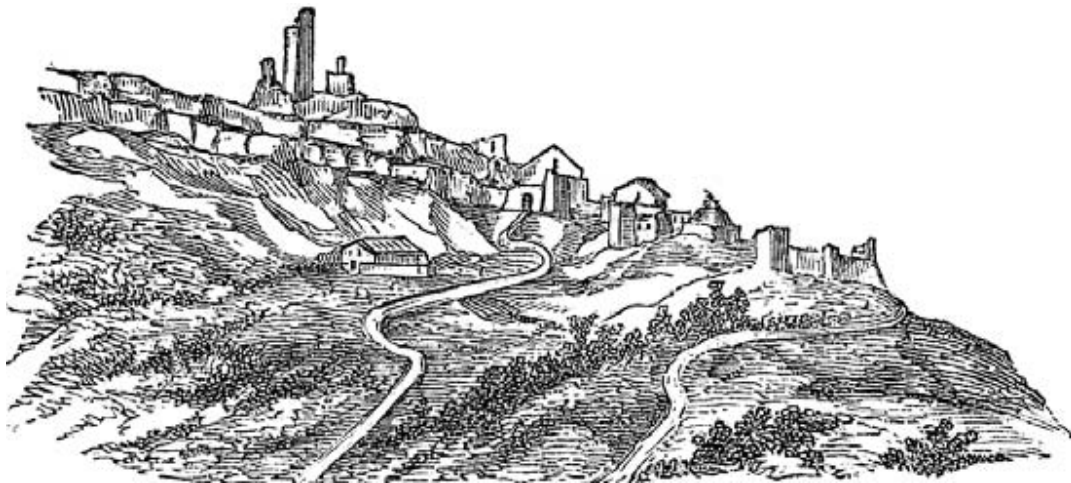

**Fig. 1** - Castello della Fava and the village of Posada (from Della Marmora 1860, fig. 10, p. 187).

Raimondo Carta Raspi, in his work concerning the castles of Sardinia, subsequently devotes a few lines to the Posada castle, recalling published material and focusing on the

vicissitudes the monument underwent during the war between the Aragonese and the Giudici of Arborea.

Dionigi Panedda is one of the few who puts forwards hypotheses concerning the original location of the ancient village of Posada: starting from his accurate bibliographic research, the scholar from Olbia states that it should be placed near the current district of Santa Caterina and that it was later transferred to the foot of the Castello della Fava.

More recently Angelo Castellaccio collected in an essay the main historical information regarding the Posada fortress, from the earliest evidence up until its final conquest by Aragon; in order to complete the data, the historian from Sassari also provides detailed information concerning the wages and the daily life, which can be reconstructed from the documents relating to the castle.

Although he referred to information which was already available in literature, Foiso Foiso has the merit of publishing some drawings concerning the Castello della Fava in his monograph devoted to Sardinian castles (fig. 2): these sketches provide hypothetical reconstructions of the cisterns located near the tower.

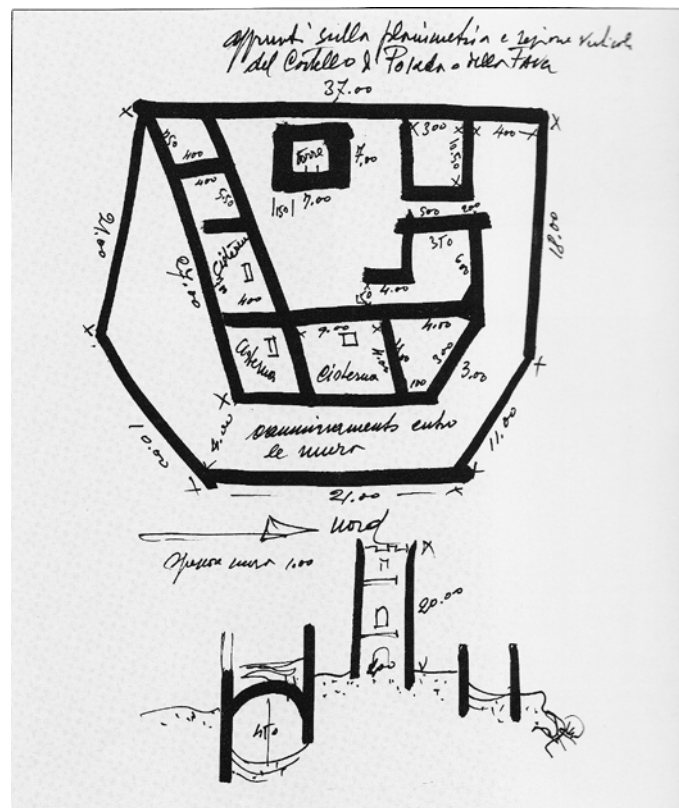

**Fig. 2** - Plan and vertical section of the Castello della Fava (from Foiso 1992, fig. 203).

Finally, in recent years, Corrado Zedda studied the fortress of Posada, especially in relation to the important port of Saint Lucia, which was presumably located in the immediate vicinity and which appears to be the reference port for lower Gallura during the second half of the XIII century.

The Castello della Fava underwent sporadic archaeological investigations; the news of the discovery of a medieval necropolis a few hundred metres from the castle, situated in *Part'e Sole* (fig. 3) dates back to 1984. The excavation revealed 17 graves (many of them of children), some were pit tombs and others were carved in stone, dating from the fourteenth and fifteenth centuries according to the elements which constituted the grave goods.

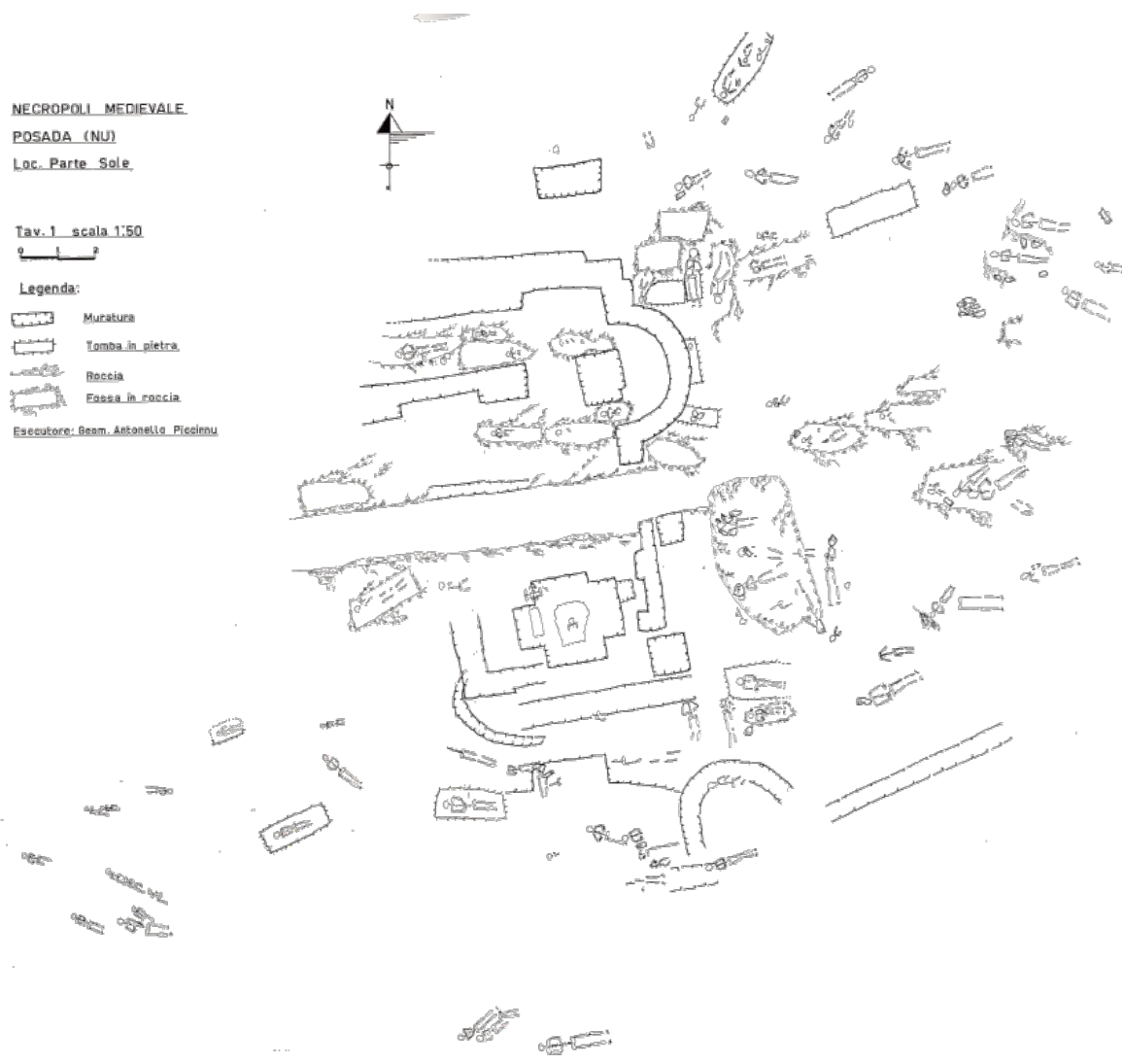

**Fig. 3** - General plan of the Necropolis of *Part'e Sole*, Posada, (from D'Oriano *et alii* 1989, fig. 41).

Subsequent interventions have allowed hypothesising that the higher part of the Posada cliff had been occupied since the early stages of the Nuraghic Age (fig. 4): a corridor-type Nuraghe (or protonuraghe), in fact, should rise in the same place where the Castello della Fava stands today. Moreover, the Nuraghe was connected with a village built on sloping terraces. In recent years, other emergency interventions carried out by the Archaeological Heritage Department in the historical centre of Posada have led to the recovery of ceramic materials which seem to indicate a discontinuous inhabitation during the Phoenician Age and then a more stable one during the Punic Age in the same area where the Nuraghe settlement had previously developed (fig. 4), with the express purpose of exploiting the mineral resources of Posada's immediate hinterland.

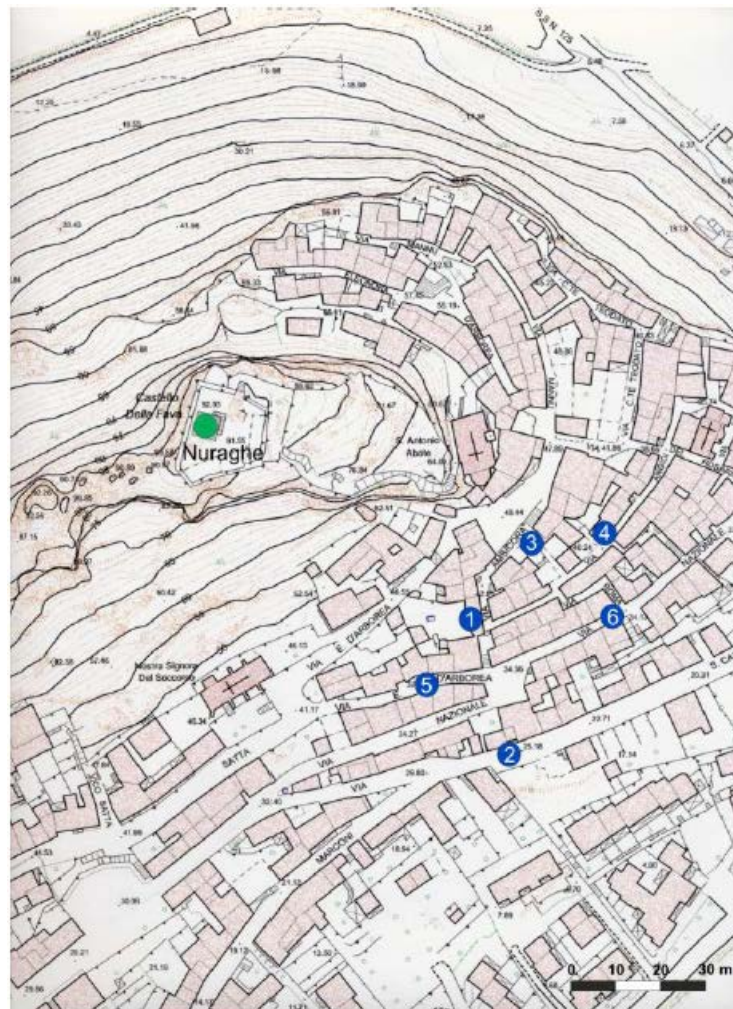

**Fig. 4** - The areas of the historical centre of Posada affected by the discovery of the archaeological material (from SANCIU 2010, fig. 2).

## ■ Credits

Coordination Prof. Rossana Martorelli

Deepening card edited by Dr. Maria Grazia Arru and Dr. Enrico Dirminti

## ■ Bibliography

ANGIUS 1847 = V. ANGIUS, s.v. *Posada*, in G. CASALIS, *Dizionario geografico storico-statistico-commerciale degli Stati di S.M. il re di Sardegna*, XV, Torino 1847, pp. 672-691.

CADONI 1992 = E. CADONI, *Joannis Francisci Farae Opera*, Sassari 1992.

CARTA RASPI 1933 = R. CARTA RASPI, *Castelli medioevali di Sardegna*. Cagliari 1933.

CASTELLACCIO 1990 = A. CASTELLACCIO, *Note sul castello de La Fava di Posada. Medioevo. Saggi e rassegne*, 15, 1990, pp. 55-84.

DELLA MARMORA 1860 = A. DELLA MARMORA, *Itinéraire de l'île de Sardaigne*, II, Turin 1860.

D'ORIANO *et alii* 1989 = R. D'ORIANO, *Posada. Località Parte Sole, necropoli medievale*, in *Il Suburbio delle città in Sardegna: persistenze e trasformazioni. Atti del III convegno di studio sull'archeologia tardoromana e altomedievale in Sardegna (Cuglieri, 28-29 Giugno 1986). Mediterraneo tardoantico e medioevale. Scavi e ricerche* 7, Taranto 1989, pp. 51-58.

FLORIS 2008 = G. FLORIS, *Il castello medioevale della Fava (Posada). Acta historica et archaeologica mediaevalia*, 29, 2008, pp. 257-297.

FOIS 1992 = F. FOIS, *Castelli della Sardegna medioevale*, Cinisello Balsamo 1992.

OGGIANU 1916 = L. OGGIANU, *La Baronìa di Posada. Parte prima. Periodo anteriore alla costituzione della Baronìa (1431). Archivio Storico Sardo*, XII, 1916, pp. 3-23.

SANCIU 2010 = A. SANCIU, *Fenici lungo la costa orientale sarda. Nuove acquisizioni. Fasti On Line Documents & Research* 174.

ZEDDA 2003 = C. ZEDDA, *Le città della Gallura Medioevale. Commercio, società e istituzioni. Ricerche storiche* 4, Cagliari 2003.

ZURITA 1610 = J. ZURITA, *Anales de la Corona de Aragón*, Zaragoza 1610.



UNIONE EUROPEA



REPUBBLICA ITALIANA



**REGIONE AUTÒNOMA DE SARDIGNA**  
**REGIONE AUTONOMA DELLA SARDEGNA**

## La Sardegna cresce con l'Europa



UNIONE EUROPEA

Progetto cofinanziato dall'Unione Europea  
Programma Operativo FESR 2007-2013

FESR - Fondo Europeo di Sviluppo Regionale - Asse I, Linea di Attività 1.2.3.a